



# Power Inductors

## Shielded Power Inductors - TCRH8D28/43 Series / 闭磁式功率电感

### Shielded Power Inductors Features

- Magnetically shielded construction
- Compact size and thin
- Large Current and Low DCR

### Applications

- DC-DC converter of portable equipment
- Camcorder, LCD television set, Digital camera, P.D.A., Notebook.

### Shielded Power Inductors Dimensions & Configurations (Unit In mm)

Type	A(max)	B(max)	C(max)	D	E	F	G	H	I
TCRH8D28	8.3	8.3	3.0	2.5	1.2	6.3	2.8	2.0	6.1
TCRH8D43	8.3	8.3	4.5	2.5	1.2	6.3	2.8	2.0	6.1

Note: Design as Customer's Requested Specifications.

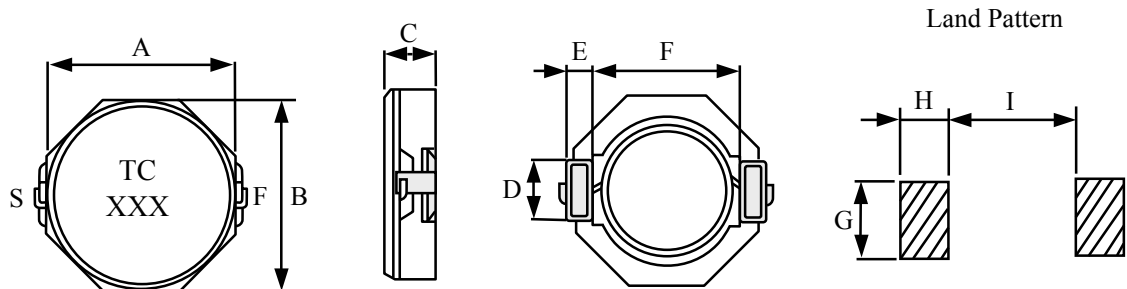

### Electrical Characteristics for TCRH8D28 Series Shielded Power Inductors

Part Number	Inductance ( $\mu\text{H}$ )	Test Freq. ( KHz )	DCR ( $\Omega$ ) (max)	IDC (A)(max)	Irms (A)(max)
TCRH8D28 - 2R5N	2.50	100	0.015	4.50	4.90
TCRH8D28 - 3R3N	3.30	100	0.018	4.00	4.40
TCRH8D28 - 4R7N	4.70	100	0.024	3.40	4.10
TCRH8D28 - 7R3N	7.30	100	0.038	2.80	3.10
TCRH8D28 - 100N	10.00	100	0.042	2.30	2.80
TCRH8D28 - 150N	15.00	100	0.066	1.90	2.10
TCRH8D28 - 220N	22.00	100	0.095	1.60	1.80
TCRH8D28 - 330N	33.00	100	0.150	1.30	1.30
TCRH8D28 - 470N	47.00	100	0.190	1.15	1.10
TCRH8D28 - 680M	68.00	100	0.280	0.92	0.83
TCRH8D28 - 101M	100.00	100	0.410	0.75	0.70

Note: Test Freq.: 100KHz / 1V.

Operating Temp.: -40°C ~ +85°C.

Inductance drop=35% typ. at IDC.

$\Delta 40^\circ\text{C}$  at Irms.





# Power Inductors

## ► Electrical Characteristics for TCRH8D43 Series Shielded Power Inductors

Part Number	Inductance (μH)	Test Freq. ( KHz )	DCR (Ω) (max)	IDC (A)(max)	Irms (A)(max)
TCRH8D43 - 2R0N	2.00	100	0.014	7.00	6.40
TCRH8D43 - 3R9N	3.90	100	0.019	5.90	5.00
TCRH8D43 - 4R7N	4.70	100	0.022	5.60	4.60
TCRH8D43 - 6R8N	6.80	100	0.025	4.40	4.20
TCRH8D43 - 100N	10.00	100	0.036	4.00	3.60
TCRH8D43 - 150N	15.00	100	0.053	2.90	2.65
TCRH8D43 - 220N	22.00	100	0.075	2.60	2.10
TCRH8D43 - 330N	33.00	100	0.125	2.25	1.60
TCRH8D43 - 470N	47.00	100	0.150	1.80	1.45
TCRH8D43 - 680N	68.00	100	0.240	1.50	1.20
TCRH8D43 - 101N	100.00	100	0.360	1.30	0.92

Note: Test Freq.: 100KHz / 1V.

Operating Temp.: -40°C ~ +85°C.

Inductance drop=35% typ. at IDC.

Δ40°C at Irms.

## ► How to Order

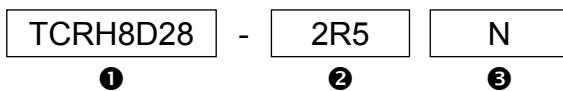

❶ Shielded Power Inductor : TCRH8D28, TCRH8D43

❷ Inductance

Code	Inductance
2R0	2.00μH
100	10.00μH
101	100.00μH

❸ Tolerance

Code	Tolerance
K	10%
L	15%
M	20%
N	30%